

**Forward control**  
**SUZUKI VL 1500 LC**  
**Art. no. 493-606/806**

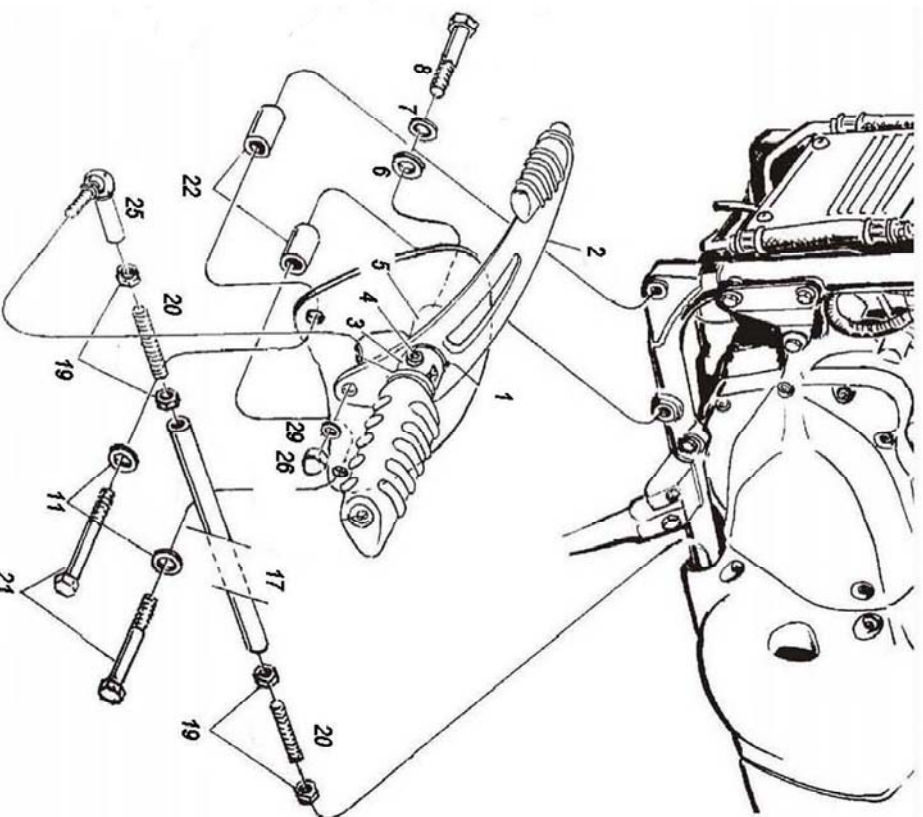
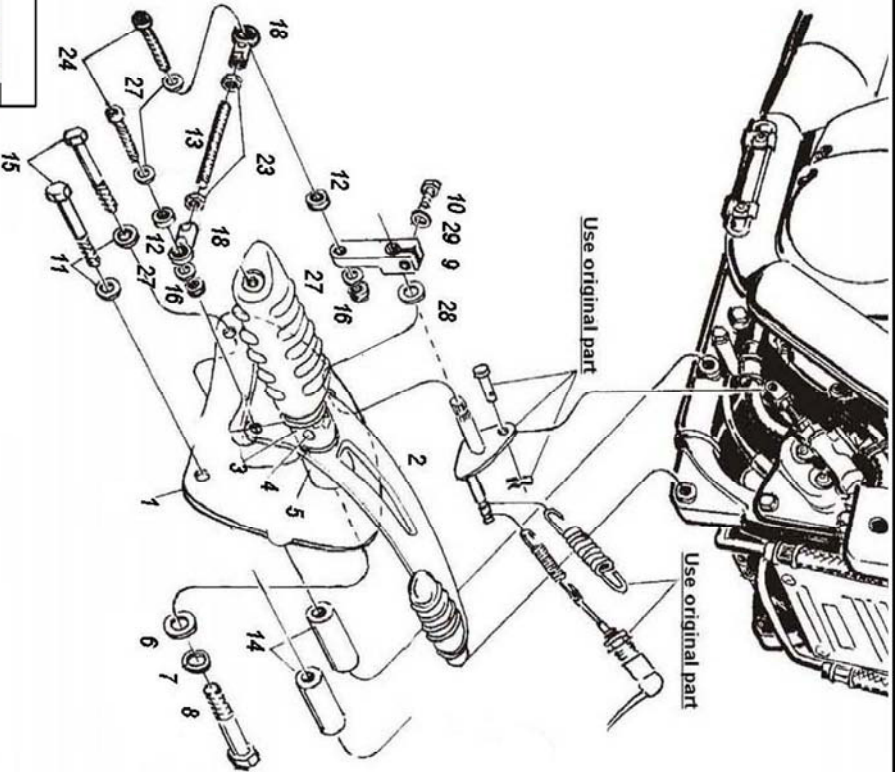

Torque		
Bolt size / thread	Steel	Steel 8.8 / Stainless
M5	6Nm	9Nm
M6	10Nm	15Nm
M8	25Nm	37Nm
M10x1.25	57Nm	83Nm
M12x1.25	101Nm	149Nm
M12	87Nm	130Nm

**Revised # 2**

Please check all fixings and mounting points before assembly as listed on the mounting instruction sheet.

This accessory should be mounted by a professional mechanic only. Motolux International B.V. / Highway Hawk can not be held responsible for improper installation.

© Motolux Specialties B.V.  
Barnveld - The Netherlands