

HIGHWAY HAWK
passion for chrome

Taillight with integrated turnsignals

Yamaha XVS 950A

Art.no. 682-100

Note: removing OEM (rear) turnsignals or change to LED, requires use of replacement Highway Hawk relay 68-2525

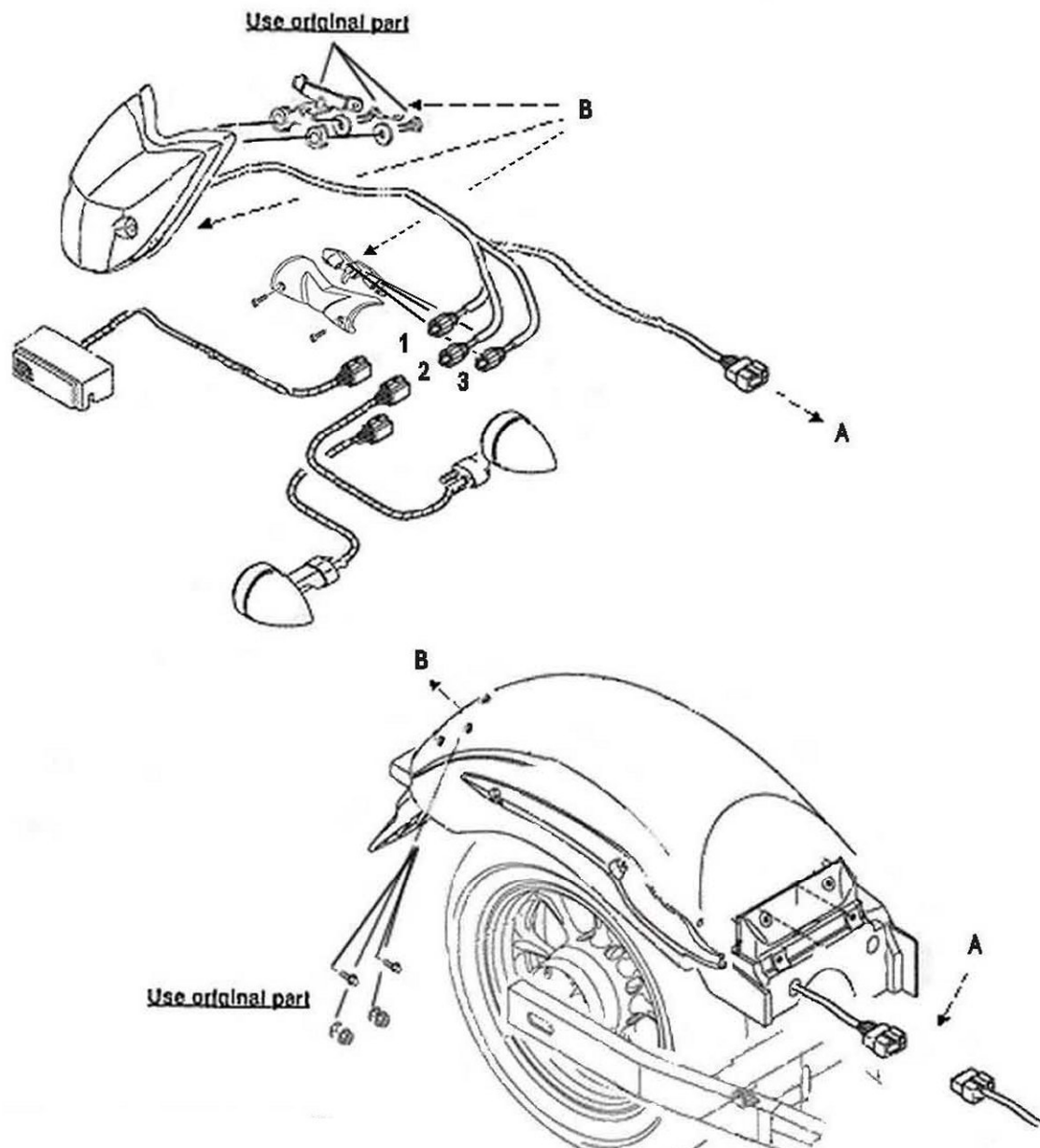

- 1) License plate light (Blue / Black)
- 2) Turnsignal Left (Brown / Black)
- 2) Turnsignal Right (Green / Black)

This accessory should be mounted by a professional mechanic only.
MotoLux International B.V. / Highway Hawk can not be held responsible for improper installation.

© Moto-Lux Specialties B.V.
Barneveld - The Netherlands